

# Solar Monitor

## Installation instructions SM2-PC

### Package contents

#### Power control module

- Solar Monitor SM2-MU
- installation instructions

#### Bus HBUS

- part for connection to SM2-MU

### 1. Step

Connect the bus HBUS SM2-MU. Connect module SM2-PC with SM2-MU as shown below.

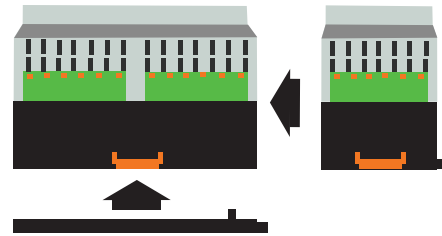

### 2. Step

#### Mechanical fastening

Solar Monitor, including any associated source modules can be mounted on wall or DIN rail mounting according to the following images.

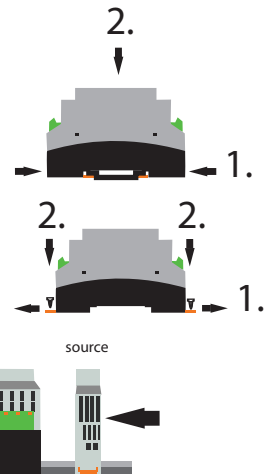

### 3. Step

#### Signal connection for power control

For proper performance management function to bring into the terminal and BCom ACOM DC-signal. The source power management (network equipment) should bring DC + signal on its common terminal. Signals for performance management are then brought to A1-A5 for the management of active power in % and the terminals B1-B5 for the management of reactive power ( $\cos \phi$ ).

The following figure shows an example circuit for active power control in increments of 0 to 30 - 60 - 100%.

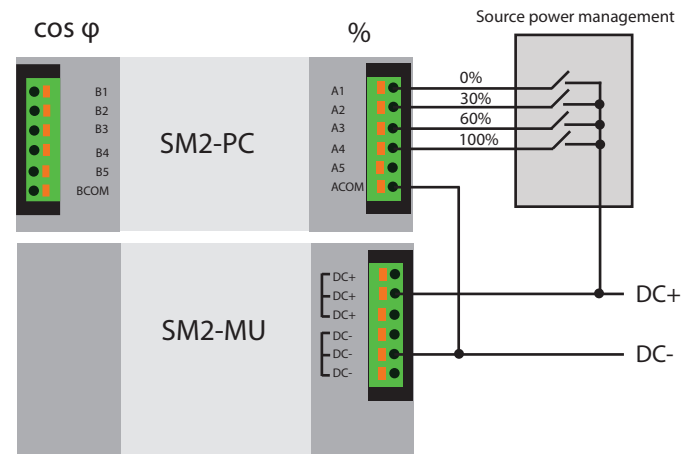

### 4. Step

#### Startup and configuration

Once the modules are connected and Solar Monitor is connected to power supply should be lit green LED Status. Otherwise, check the connection module SM2-MU.

In the browser menu to open the "System Settings / Performance Management."

You need to set different combinations of inputs and their corresponding values in % of performance management, or the value of  $\cos \phi$ .

To use the power management module for more Solar Monitor, select them in the "Remote" in "Source of performance management."

Next fill in the address SM2-MU, which is connected to the power control module.

